

- A - thermostat housing
- B - potentiometer housing
- C - the heater
- D - heater carrier (1/2")
- E - indicator lamp
- F - potentiometer button
- G - electrical cable

### Advantages of GTX and GT

- made of high quality components
- precise temperature control
- heater operation indicator ring-shaped
- rubber seal prevents water leakage
- thermal fuse prevents overheating
- housing made of two elements what make that the access to the potentiometer is easiest
- design is in tune with modern and traditional radiators and towel heaters
- energy savings – possibility of heating only one room outside the heating period; it is not necessary to start whole central heating (after installation T-fitting)
- ecological solution – tube made of carton

GT 150	GT 300	GT 600	GT 900	GT 1200
150	300	600	900	1200
230v-50Hz				
5 -70° ±3°C				
OMY 3 x 0,75			OMY 3x1	
94°C				
G 1/2"				
I				
355	365	390	416	440
295	312	360	410	460

#### Type

- Electric power supply
- Heater power (W)
- Temperature regulation
- Connecting cable, 1,3 m
- Fuse melting temperature
- Mechanical connection
- Insulation class
- Weight GT (g)
- Length, L (mm)

### GTX with heating elements made of stainless steel.

GTX 150	GTX 300	GTX 600	GTX 900
150	300	600	900
363	400	415	435
253	312	360	410

#### Type

- Heater power (W)
- Weight GT (g)
- Length (mm)

Connecting cable – straight or spiral.



Special „S“ key is used to install the heaters into radiators.

### The heaters are produced in colors:

- white
- satin
- grey
- brass

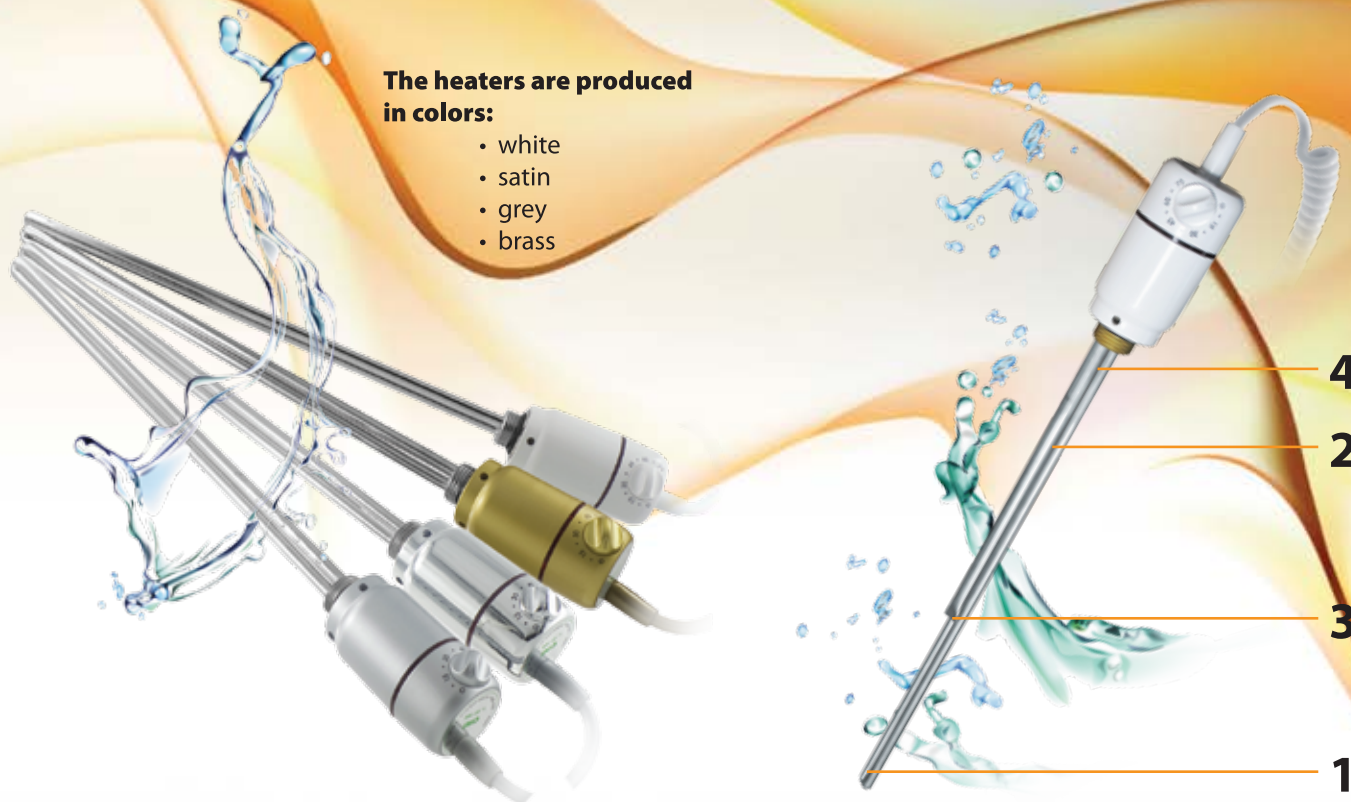

## model GTX

The new model GTX is the effect of CINI's presence in the Polish and European market and the previous experience with heating technology.

GTX lifetime is extended through the use of heating elements in stainless steel (1). It was added capillary (2) with temperature sensor (3) at the end. The measurement is very accurate right now. You can control precisely fluid temperature, in which the heating element is immersed. The special fuse (4) protects model GTX against dry running in case of loss of water. It is important that our heating elements are made of well-known and proven leader among manufacturers – Backer OBR.

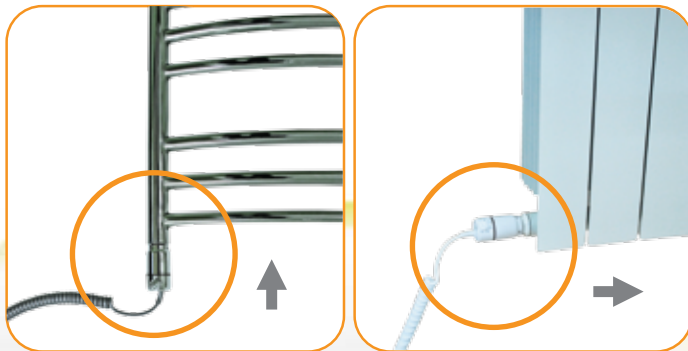

The heater GTX with electronic thermostat is dedicated for the radiators connected with the central heating or for electrical radiators and towel heaters. This model is the best choice for radiator made off stainless steel.

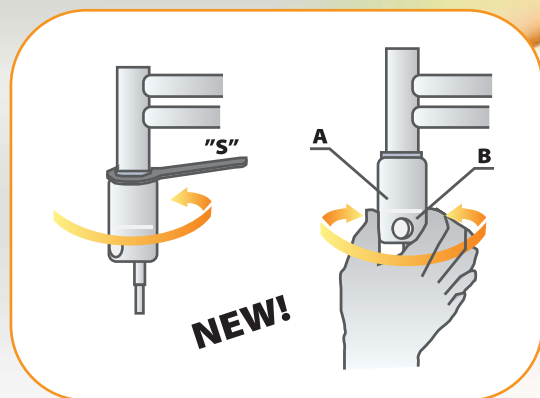

Models GTX and GT have innovative housing solution.

It consists of two elements:

- first - immobile element (A) with the base of the heating element
- second – mobile element (B) rotates around its own axis, it made that the access to the potentiometer is optimum.



**ELECTRIC HEATER WITH ELECTRONIC THERMOSTAT**

**model GT**

**CINI**

Sp. z o. o.

ul. Borowa 85  
41 - 253 Czeladź, Polska

tel. + 48 32 265 65 33 e-mail: [cini@cini.com.pl](mailto:cini@cini.com.pl)  
fax. + 48 32 265 30 37 [www.cini.com.pl](http://www.cini.com.pl)

**model GTX**

**CINI**

Sp. z o. o.

ul. Borowa 85  
41 - 253 Czeladź, Polska

tel. + 48 32 265 65 33 e-mail: [cini@cini.com.pl](mailto:cini@cini.com.pl)  
fax. + 48 32 265 30 37 [www.cini.com.pl](http://www.cini.com.pl)